



Project Name:	
Type:	Date:
Catalog #:	

**Description:**

The Nulite RCT series meets “dark sky requirements” with full cut-off when down lighting only. Optional up/down light for an aesthetic appearance. This luminaire is offered in compact fluorescent, pulse start metal halide and high pressure sodium.

**Specifications:**

**Construction:** Die cast aluminum housing, tempered clear glass lens, engineered aluminum reflector - wide or forward throw distribution and powder coat paint finish - bronze (standard), white or black optional. Consult factory for custom colors.

**Reflector / Ballast:** Reflector is specular aluminum engineered for performance with three distribution options - wide throw, forward throw or Up/Down. Ballast is electronic for CFL and open core & coil style for HID.

**Lamping:** 1 lamp compact fluorescent, metal halide or high pressure sodium. Luminaire can be ordered with lamps, consult factory.

**Mounting:** Wall mounted for down lighting only. Designed to mount to an adequately supported 4” octagonal recessed outlet box by others.

**Labels:** UL / cUL listed, suitable for Wet locations in down lighting applications only.

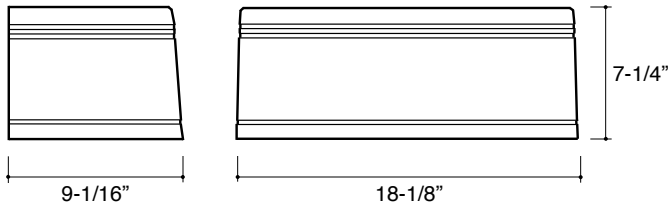

**Mounting Plate (Gasketed)**

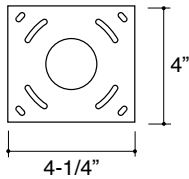

**Ordering Information**

Sample: RCT-142CFTR-277-BK-PC-WT

Series	Wattage	Voltage	Color	Options
RCT				
	<b>Compact Fluorescent</b>	UNV <sup>1</sup>	BZ Bronze (Standard)	PC <sup>4</sup> Photocell
	126CFQ (1) 26W/G24q-3	120	BK Black	U/D Up/Down Optics (Does not affect UL)
	132CFTR (1) 32W/GX24q-3	277	WH White	WT Wide Throw Optics (Standard)
	142CFTR (1) 42W/GX24q-4	347 <sup>2</sup>	Consult factory for custom colors.	FT Forward Throw Optics
	<b>High Pressure Sodium</b>	480 <sup>2</sup>		GLR Fusing
	70HPS 70W HPS/MED	MT <sup>3</sup> Multi-Tap 120/208/ 240/277		-20 <sup>5</sup> -20°F Cold Start Ballast
	100HPS 100W HPS/MED			EM <sup>5</sup> Emergency Battery Pack
	150HPS 150W HPS/MED			EMLT-4 <sup>5</sup> Low Temperature -4°F Emergency Battery Pack
	<b>Pulse Start Metal Halide</b>			
	70MH 70W MH/MED			
	100MH 100W MH/MED			
	150MH 150W MH/MED			

**Notes**

1. Universal voltage from 120 to 277V for compact fluorescent only.
2. Voltage option for HID only. 480 not available for all wattages, consult factory.
3. Multi-Tap ballast for HID only.
4. Specific voltage must be ordered for photocell option.
5. Compact fluorescent only. Specific voltage must be specified for EM.

